

Listed on State Register

VT ACHP

Date:

5/24/88

STATE OF VERMONT
Division for Historic Preservation
Montpelier, VT 05602

HISTORIC SITES & STRUCTURES SURVEY
District ☒ Complex ☐ Survey Form

COUNTY: Grand Isle

TOWN: Isle La Motte

LOCATION: Route 129 north and south of
intersection of Ferry Road

NAME OF DISTRICT:

Village Center District

TYPE OF DISTRICT:

Residential, Public Buildings

PHYSICAL CONDITION OF STRUCTURES:

Excellent 6% Good 53%

Fair 35% Poor 6%

LEVEL OF SIGNIFICANCE:

Local ☐ State ☒ National ☐

THEMES:

STATEMENT OF SIGNIFICANCE:

The Village Center District extends down either side of the Main Road of Isle La Motte at the center of the village where the two principal roads cross: the area commonly called the Four Corners. Although the buildings include a cross section of styles and time periods, they represent a cohesive unit of vernacular structures at the center of the island with very few non-contributing buildings. The district has continued as a cultural, commercial and residential hub for Isle La Motte since the first half of the 19th century. It includes some of the earliest and most elaborately, embellished structures in the town.

THREAT TO STRUCTURES:

No Threat ☒ Zoning ☐ Roads ☐
Development ☐ Deterioration ☐
Alteration ☐ Other:

SURVEY NUMBER: 0703-13

NEGATIVE FILE NUMBER(S):

81-A-61, 81-A-72

UTM REFERENCES: (See continuation sheet)

Zone/Easting/Northing

A 18/631190/4970590

B 18/631240/4970570

C 18/631230/4970560

D 18/631280/4970530

U.S.G.S. QUAD. MAP:

Rouses Point 15' Quad.

COMPLEX INFORMATION ONLY

COMMON NAME:

PRESENT FORMAL NAME:

ORIGINAL FORMAL NAME:

TYPE OF COMPLEX:

TYPES OF STRUCTURES:

PRESENT USE:

ORIGINAL USE:

ARCHITECT/ENGINEER:

BUILDER/CONTRACTOR:

ACCESSIBILITY TO PUBLIC:

Yes ☐ No ☐ Restricted ☒

LOCAL ATTITUDES:

Positive ☒ Negative ☐
Mixed ☐ Other:

MAP: (1. Indicate NORTH in circle. 2. Represent each structure as an open box. 3. Number each structure inside of its box.)

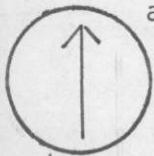

FERRY ROAD

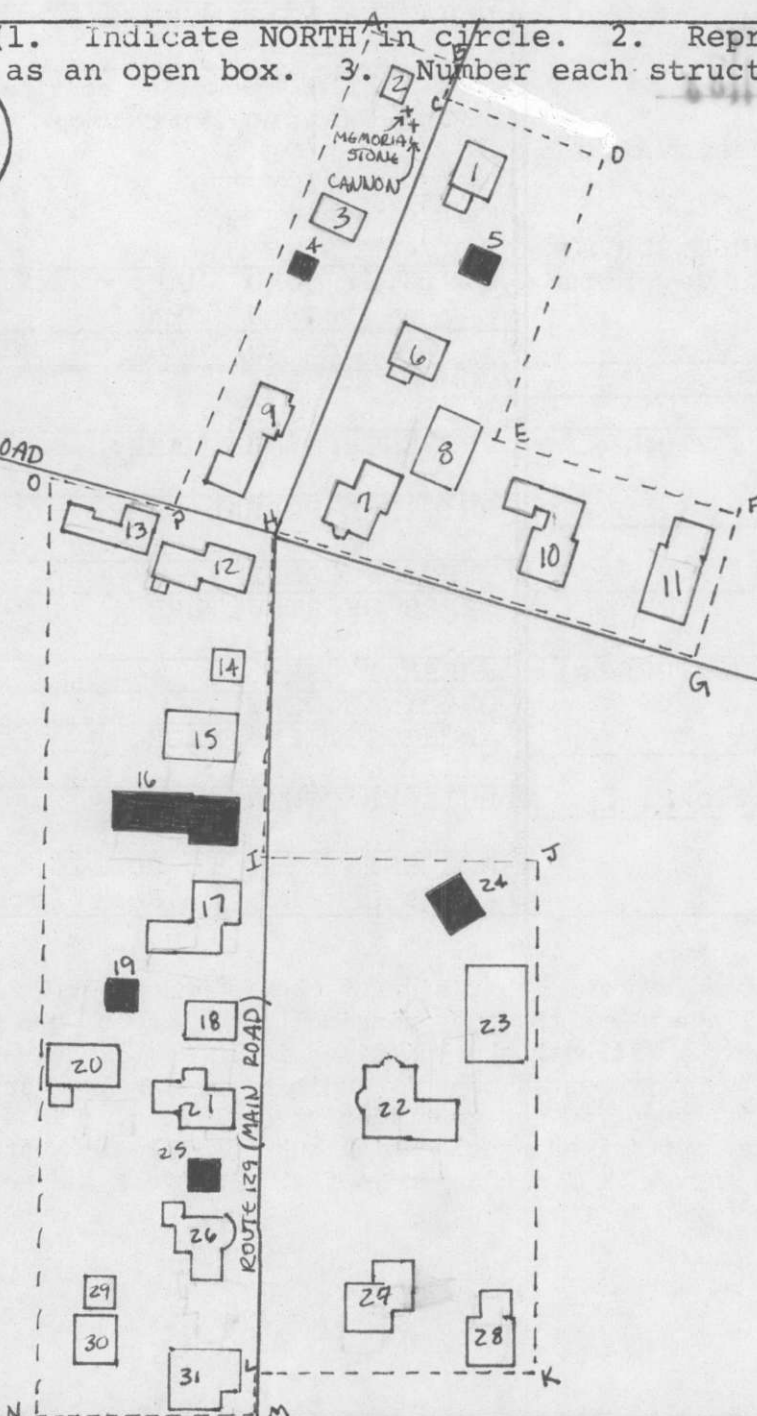

BOUNDARY DESCRIPTION: The boundary of the Village Center District begins at Pt.A, the northernmost point of the library property (#2). It then proceeds southeasterly along the north property line of the library to the northwest right-of-way of Rt.129 at the eastern corner of the library property. It then proceeds generally southwest along said right-of-way to Pt.C, the intersection of a line extending parallel to and 25 feet northeast of the northeast facade of the Volunteer Fire Co. (#1). The boundary thence proceeds along said extension to Pt.D, the northeast border of the Volunteer Fire Co. property. It then proceeds generally southwest along the rear property lines of #1, 5, and 6 to Pt.E, the northeast corner of the property (#7 & 8) from there it proceeds southeasterly along the rear property line of the Yoke House (#10) and the Methodist Church (#11) to Pt.F, the northeast corner of the Church property. It then proceeds southwesterly along the west border of the church's property to Pt.G, the southeast corner of the church's property. It then proceeds northwesterly along the north right-of-way of Ferry Road and crosses Rt.129 to Pt.H, the northwest right-of-way of the intersection of Rt.129 and Ferry Road. It thence proceeds south across

REFERENCES:

Interview with Mrs. DeSarno, Unpublished notes on houses owned by IIM Historical Society, Beers Atlas, Wallings Map.

RECORDED BY:

ORGANIZATION:

DATE RECORDED:

Karen L. Kiernec

Division for Historic Preservation

1-26-81

OUTSTANDING COMPONENTS OF DISTRICT <input checked="" type="checkbox"/>		COMPLEX <input type="checkbox"/>
(Include individual survey number ONLY if surveyed individually.)		
MAP NUMBER: 1	DATE BUILT: 1910	SURVEY NUMBER:
FUNCTIONAL TYPE:		NEGATIVE FILE NUMBER: 81-A-61
COMMON NAME: Volunteer Fire Co., Inc.		OWNER:
DESCRIPTION:		
<p>A square, 2-story, hip-roofed building with a hip-roofed cupola that has louvred windows. The structure is sheathed in clapboards and trimmed with a box cornice, and cornerboards. Windows are 2/2 with plain molding and lip-molded lintels. There is a new one-story right wing with vertical siding, a rear exterior concrete chimney, and a small shed-roofed ell.</p>		
MAP NUMBER: 2	DATE BUILT: 1840	SURVEY NUMBER:
FUNCTIONAL TYPE: Library		NEGATIVE FILE NUMBER: 81-A-61
COMMON NAME:		OWNER:
DESCRIPTION:		
<p>An eaves-front, 1½-story, stone building with a slate-covered roof and an interior stone chimney at each end. Trim includes a molded cornice and cornice returns. In front is portico with pedimented roof and square stone pier supports. Windows are 12/1, 16/1 and 20/1 with stone lintels. In the left facade gable is a stained glass lunette added during a 1907 renovation when the building was converted to a library. It was originally owned by the Hill family and was supposedly a two-family dwelling. It was built by James Ritchie who also built the other stone structures in the town.</p>		
MAP NUMBER: 3	DATE BUILT: c.1900	SURVEY NUMBER:
FUNCTIONAL TYPE: Town Office		NEGATIVE FILE NUMBER: 81-A-61
COMMON NAME:		OWNER: Town of Isle La Motte
DESCRIPTION:		
<p>A 2-story, gable-front, metal-roofed, pedimented building with a brick, interior chimney with corbeled cap. Trim includes a molded cornice, projecting eaves, and cornerboards. The building is sheathed in clapboards. Windows are 2/2 at the 2nd story, the first floor has a new picture window in front and a garage door on the right facade. There was a school on the 2nd floor of the building from 1912-1931.</p>		
MAP NUMBER: 4	DATE BUILT: mid 20thc	SURVEY NUMBER:
FUNCTIONAL TYPE:		NEGATIVE FILE NUMBER:
COMMON NAME:		OWNER: Telephone Company
DESCRIPTION:		
<p>A non-contributing, brick, gable front, 1-story shed with an asphalt-shingle-covered roof.</p>		

OUTSTANDING COMPONENTS OF DISTRICT <input checked="" type="checkbox"/>		COMPLEX <input type="checkbox"/>
(Include individual survey number ONLY if surveyed individually.)		
MAP NUMBER: 5	DATE BUILT:	SURVEY NUMBER:
FUNCTIONAL TYPE:	NEGATIVE FILE NUMBER:	
COMMON NAME:	OWNER:	
DESCRIPTION:		
<p>A non-contributing, eaves-front, 1½-story house with an asphalt-shingle-covered roof and clapboard siding. Very poor condition.</p>		
MAP NUMBER: 6	DATE BUILT: c.1865	SURVEY NUMBER:
FUNCTIONAL TYPE:	NEGATIVE FILE NUMBER: 81-A-61	
COMMON NAME: Mason's Building	OWNER:	
DESCRIPTION:		
<p>A 2-story, gable-front building with an interior brick chimney at the ridge. It has clapboard siding and a stone foundation (with concrete over it). It exhibits a molded cornice, cornice returns, and cornerboards. Windows are 2/2 with wide trim and lip-molded lintels, and in front there are large store front windows. A 1-story, porch spans the front and is supported by turned posts. The front door is recessed between the 2 large windows. It was operated by William H. Naylor as a store between 1890 to 1940. It was also a Post Office at one time.</p>		
MAP NUMBER: 7	DATE BUILT: c.1878	SURVEY NUMBER:
FUNCTIONAL TYPE: Residence	NEGATIVE FILE NUMBER: 81-A-61	
COMMON NAME:	OWNER: Michael Mooney	
DESCRIPTION:		
<p>An L-shaped, 1½-story house with a steeply pitched asphalt-shingle-covered roof. It has a gable front main block with an eaves front left wing. There is an interior brick chimney and a concrete chimney. Sheathed in clapboards, the house has boxed eaves, cornerboards and a stone foundation. Most of the windows are 2/2 with architrave cornices. The front has double, long, narrow 1/1 and a small 1/1 window with a triangular pediment above it. The front double-doors have a hood supported by elaborately carved brackets with pendant drops. Serpentine, boxed stoop railings flank the entrance and curve out from the steps and end in small newel posts. On the right wall is a polygonal bay windows with 1/1 sash, small brackets supporting the eaves and panels below the window. There is a porch behind the main block with pierced posts, and bracketed</p>		
MAP NUMBER: 7 cont.	DATE BUILT:	SURVEY NUMBER:
FUNCTIONAL TYPE:	NEGATIVE FILE NUMBER:	
COMMON NAME:	OWNER:	
DESCRIPTION:		
<p>cornice. The left wing has a 1-story, front porch with pierced posts, paired brackets and a lattice skirt.</p>		

0703-13 Village Center District
Isle La Motte
BOUNDARY DESCRIPTION CONTINUED

y Road and along the west edge of the right-of-way of Rt.129 to Pt.I, the northeast corner of the LaBombard property (#17). The boundary thence proceeds west in a line extending across Rt.129 from the northern border of the LaBombard property to Pt.J, the intersection of a line extending parallel to and 20 feet west of the west facade of the Fentine barn (#23). It thence proceeds south along said extension to the southwest corner of the DeSarno property (#27 & 28) to Pt.K, the southwest corner of the DeSarno property (#27 & 28). It thence proceeds west along the south property line of the DeSarno's and crosses Rt.129 to Pt.L, the west edge of the right-of-way of Rt.129. The boundary thence proceeds south along said right-of-way to Pt.M, the southeast corner of the Isaac property (#29, 30 & 31). It thence proceeds west along the south property line of the Isaac property to Pt.N, the southwest corner of said property. It then proceeds north along the rear property line of #'s 31, 26, 21, 18, 17, 14, and 12 to Pt.O, the southern edge of the right-of-way of the Ferry Road and the northwest corner of the Andrew's property. It thence proceeds generally southeasterly along said right-of-way to Pt.P, the intersection of a line extending from the rear property lines of #9, 3 & 1. It thence proceeds northeasterly along said property line back to Pt.A, the point of beginning.

UTM References: (cont.)

E.18/631260/4970440
F.18/631320/4970420
G.18/631300/4970380
H.18/631180/4970440
I.18/631150/4970190
J.18/631240/4970200
K.18/631230/4970080
L.18/631140/4970080
M.18/631140/4970030
N.18/631060/4970030
O.18/631090/4970460
P.18/631130/4970440

OUTSTANDING COMPONENTS OF DISTRICT <input checked="" type="checkbox"/>		COMPLEX <input type="checkbox"/>
(Include individual survey number ONLY if surveyed individually.)		
MAP NUMBER: 8	DATE BUILT:	SURVEY NUMBER:
FUNCTIONAL TYPE: Barn		NEGATIVE FILE NUMBER: 81-A-61
COMMON NAME:		OWNER: Michael Mooney
DESCRIPTION:		

A large, eaves-front barn with asphalt shingle-covered roof. It has clapboard siding, cornerboards, and small 2/2 windows.

MAP NUMBER: 9	DATE BUILT: 1822	SURVEY NUMBER:
FUNCTIONAL TYPE:		NEGATIVE FILE NUMBER: 81-A-61
COMMON NAME:		OWNER: Richard Middleton
DESCRIPTION:		

A 2½-story, eave-front, 3x2 bay house with an asphalt shingle-covered roof and a brick, interior end chimneys. It has a molded cornice, cornice returns, and a stone foundation. The front, center, double doors are flanked by paneled pilasters. Windows are 2/2. There is a 2-story bay window with projecting eaves supported by paired brackets on both floors. There are 2/2 windows in the second floor and tall, narrow 1/1 sash on the ground floor.

To the left and rear of the main block is an eaves-front wing. It has a metal-covered roof with 8/8 and 2/2 windows. The building was built by James Ritchie for Ira Hill and later became a hotel called the Hill House Hotel. The left end served as a Cider Mill when the building was a hotel.

MAP NUMBER: 10	DATE BUILT: c.1875	SURVEY NUMBER:
FUNCTIONAL TYPE:		NEGATIVE FILE NUMBER: 81-A-61
COMMON NAME:		OWNER: Rev. C. Fred & Louise Yohe
DESCRIPTION:		

A 1½-story, gable-front house with a brick, interior chimney at the rear. The building is sheathed in clapboards and has a random, fieldstone foundation. There is a louvred triangular window in the gable and 2/2 windows with lip-molded lintels in the rest of the house. The front door is shouldered and topped with a cornice molding. The 1-story, porch spans the front and right facades and is supported by turned posts on pedestals with brackets. The right and left facades have small, rectangular windows under the eaves. Behind the main block is a new 1-story addition with a brick interior chimney. To the left of the addition is a new vertical sided, 2-stall garage with asphalt shingle-covered roof. The house served for many years as the Methodist Parsonage.

MAP NUMBER: 11	DATE BUILT: c.1843	SURVEY NUMBER:
FUNCTIONAL TYPE: Church		NEGATIVE FILE NUMBER: 81-A-61
COMMON NAME:		OWNER:
DESCRIPTION:		

A 2-story, stone, gable-front church with a slate-covered roof, and box cornice with frieze. Fenestration consists of stained glass windows with heavy stone lintels and sills. The recessed, double-leaf front doors have paneled reveals. The top of the paneled doors have small square lights. Above the church is a two-stage belfry. The 1st stage is clapboarded with a full entablature; the 2nd stage is clapboarded and has louvred windows. The roof of the belfry has 4 pedimented gables. There is a gable-front, 1-story, asphalt-shingle-roofed ell addition with clapboard siding, 6/6 windows with lip-molded lintels, and a brick interior chimney at the ridge. The eaves-front barn attached to the ell was originally used for carriages. The interior of the church has curly brick

OUTSTANDING COMPONENTS OF DISTRICT <input checked="" type="checkbox"/>		COMPLEX <input type="checkbox"/>
(Include individual survey number ONLY if surveyed individually.)		
MAP NUMBER: 11 cont.	DATE BUILT:	SURVEY NUMBER:
FUNCTIONAL TYPE:	NEGATIVE FILE NUMBER:	
COMMON NAME:	OWNER:	
DESCRIPTION:		
<p>wainscoting. The interior of the double doors are grained. The basement has a pressed metal tile ceiling, and wood columns.</p> <p>The church was built by James Ritchie from Isle La Motte block marble from the Ira Hill quarry on the east shore. At some point (some accounts say 1840's, other 1856), the interior burned and was redone.</p>		

MAP NUMBER: 12	DATE BUILT: c.1840	SURVEY NUMBER:
FUNCTIONAL TYPE: Residence	NEGATIVE FILE NUMBER: 81-A-61	
COMMON NAME:	OWNER: Mrs. F. Emerson Andrews	
DESCRIPTION:		
<p>A 1½-story, gable-front brick house with a molded box cornice, frieze, and cornice returns. It has two two brick, interior chimneys. The 1-story porch spans the right, front and left facades and is supported by pierced posts with lattice-work bracing and 5-curved brackets. The porch roof balustraded. A second floor door in the gable opens onto the deck. The left facade has a triple window, shed dormer. The right facade has a polygonal bay window.</p> <p>Behind the main block is a clapboarded ell with five shed-roofed wall dormers and a gabled dormer. There is an interior, concrete chimney right of the ridge and a brick, interior chimney left of it. Part of the ell was probably originally a carriage house because it has the characteristic basket handle</p>		

MAP NUMBER: 12 cont.	DATE BUILT:	SURVEY NUMBER:
FUNCTIONAL TYPE:	NEGATIVE FILE NUMBER:	
COMMON NAME:	OWNER:	
DESCRIPTION:		
<p>arched opening on the right facade (although it has been filled in).</p> <p>Beers Atlas of 1871 lists the property as being a store and post office.</p> <p>At that time it belonged to H.C. Hill. It is also on Wallings Map of 1857.</p>		

MAP NUMBER: 13	DATE BUILT: late 19th	SURVEY NUMBER:
FUNCTIONAL TYPE: Barn	NEGATIVE FILE NUMBER: 81-A-61	
COMMON NAME:	OWNER: Mrs. F. Emerson Andrews	
DESCRIPTION:		
<p>A U-shaped barn with clapboard and novelty siding. It has a metal-covered roof, decorative bargeboards and a stone foundation. There is a 12/12 sash on the left facade.</p>		

OUTSTANDING COMPONENTS OF DISTRICT <input checked="" type="checkbox"/>		COMPLEX <input type="checkbox"/>
(Include individual survey number ONLY if surveyed individually.)		
MAP NUMBER: 14	DATE BUILT: c.1830	SURVEY NUMBER:
FUNCTIONAL TYPE: Residence	NEGATIVE FILE NUMBER: 81-A-61	
COMMON NAME: Mrs. Arthur H. Hill House	OWNER: Amanda Beard	
DESCRIPTION:		
<p>An eaves-front, 1½-story house with a brick, interior chimney at the ridge. The house is sheathed in clapboards and has a stone foundation. It is trimmed with a boxed cornice and cornerboards. There are two doors in front, the right one is topped by a gabled hood. In the rear is a lean-to which makes the house look like a saltbox.</p> <p>The house is supposedly one of the two oldest houses on the island and is of log construction. It originally belonged to Mrs. Arthur H. Hill.</p>		
MAP NUMBER: 15	DATE BUILT: late 19thc	SURVEY NUMBER:
FUNCTIONAL TYPE: barn	NEGATIVE FILE NUMBER: 81-A-72	
COMMON NAME:	OWNER: Amanda Beard	
DESCRIPTION:		
<p>A gable-front barn with vertical siding, a sheet metal-covered roof, and small 9-light windows with plain trim.</p>		
MAP NUMBER: 16	DATE BUILT: Mid 20thc	SURVEY NUMBER:
FUNCTIONAL TYPE: garage	NEGATIVE FILE NUMBER:	
COMMON NAME:	OWNER:	
DESCRIPTION:		
<p>A non-contributing, gable-front, 1-story garage.</p>		
MAP NUMBER: 17	DATE BUILT: c.1865	SURVEY NUMBER:
FUNCTIONAL TYPE: Residence	NEGATIVE FILE NUMBER: 81-A-72	
COMMON NAME:	OWNER: Norma & Robert La Bombard	
DESCRIPTION:		
<p>An eaves-front, 1½-story building with a hip roof and clapboard siding. On the left facade of the wing is a clipped gable, cornice returns and a bank of 4 2/2 windows. There is a deck in back. To the right of the wing is a newer (early 20th c.) 2-story, square, hip-roofed block. It has a bracketed cornice. The full front porch, which is similar to others in Isle La Motte (0703-8), is a vernacular interpretation of the Bungalow style. It has a shallow-pitched, gable front with shingled, tapered piers up to imposts that curve into a plain frieze. Windows are 2/2 and 1/1 with plain trim. The right block has a concrete foundation, a brick exterior chimney on the right and a bulkhead in the rear. Original owner F. Fortune.</p>		

OUTSTANDING COMPONENTS OF DISTRICT <input checked="" type="checkbox"/>		COMPLEX <input type="checkbox"/>
(Include individual survey number ONLY if surveyed individually.)		
MAP NUMBER: 18	DATE BUILT: c.1850	SURVEY NUMBER:
FUNCTIONAL TYPE: Residence	NEGATIVE FILE NUMBER: 81-A-72	
COMMON NAME:	OWNER: Stanley LaBombard	
DESCRIPTION:		
<p>A 1½-story, 3x2 bay, gable-front house with an interior brick chimney. It has a cornice, clapboard siding, and cornerboards. Windows are 2/2 with plain trim and lip-molded lintels. There is a door in the gable with a 6/6 window on each side. Originally, the property of H.H. Hill.</p>		
MAP NUMBER: 19	DATE BUILT: late 19th	SURVEY NUMBER:
FUNCTIONAL TYPE: barn	NEGATIVE FILE NUMBER:	
COMMON NAME:	OWNER: Stanley LaBombard	
DESCRIPTION:		
<p>A non-contributing, gable roofed barn with a sheet metal covered roof.</p>		
MAP NUMBER: 20	DATE BUILT: late 19th	SURVEY NUMBER:
FUNCTIONAL TYPE: barn	NEGATIVE FILE NUMBER: 81-A-72	
COMMON NAME:	OWNER: Joseph & Eleanor Patnode	
DESCRIPTION:		
<p>A gable-front barn with clapboard siding and an asphalt shingle-covered roof.</p>		
MAP NUMBER: 21	DATE BUILT: c.1920	SURVEY NUMBER:
FUNCTIONAL TYPE: Residence	NEGATIVE FILE NUMBER: 81-A-72	
COMMON NAME:	OWNER: Joseph and Eleanor Patnode	
DESCRIPTION:		
<p>A 1½-story, eaves-front, shingled house with a brick interior chimney on the right and a concrete chimney on the left. There is a shed wall dormer in front. The house has a box cornice with returns. The 1-story front porch has a shallow pitched gable roof with tapered, shingled piers that extend up to imposts which curve into a plain frieze. Windows are 2/2 and 1/1 with plain trim and lip-molded lintels.</p> <p>There is a 1-story, small right wing and a rear shed-roofed ell with a flat-roofed projecting behind that.</p>		

OUTSTANDING COMPONENTS OF DISTRICT <input checked="" type="checkbox"/>		COMPLEX <input type="checkbox"/>
(Include individual survey number ONLY if surveyed individually.)		
MAP NUMBER: 22	DATE BUILT: c.1878	SURVEY NUMBER:
FUNCTIONAL TYPE: Residence	NEGATIVE FILE NUMBER: 81-A-72	
COMMON NAME: Old Orchard House	OWNER: Louis Fentine	
DESCRIPTION:		
<p>A 1½-story, clapboarded, eaves-front house with a center gable-front projection. The steeply pitched roof is covered with asphalt shingles. There is an interior brick chimney at the ridge. It has a box cornice without returns. The front projection has a 2-story bay window, with paired, scrolled brackets supporting the eaves. Beneath the long narrow windows are square, paneled sections with a lozenge design in the center. On either side of the projection are entrances and porches. The doors have double, narrow, round-arched lights. The porch roofs are supported by pierced posts with paired brackets. The right and left facades have 1-story bay windows with details similar to the front bay window. Windows in the rest of the house are 1/1 with wide trim and a cornice supported by small</p>		
MAP NUMBER: 22 cont	DATE BUILT:	SURVEY NUMBER:
FUNCTIONAL TYPE:	NEGATIVE FILE NUMBER:	
COMMON NAME:	OWNER:	
DESCRIPTION:		
<p>brackets. In the center of the cornice is a keystone which angles out from the top of the window. Behind the house is a new, mid 20th century, ell with a gable roof and clapboard siding. Built and originally owned by Oliver J. Thomas.</p>		
MAP NUMBER: 23	DATE BUILT: Late 19th	SURVEY NUMBER:
FUNCTIONAL TYPE: Barn	NEGATIVE FILE NUMBER: 81-A-72	
COMMON NAME:	OWNER: Louis Fentine	
DESCRIPTION:		
<p>An eaves-front barn with clapboard siding and an asphalt shingle covered roof.</p>		
MAP NUMBER: 24	DATE BUILT: mid 20th	SURVEY NUMBER:
FUNCTIONAL TYPE: garage	NEGATIVE FILE NUMBER:	
COMMON NAME:	OWNER: Louis Fentine	
DESCRIPTION:		
<p>A gable-front, clapboarded garage with an asphalt shingle-covered roof. Non-contributing.</p>		

OUTSTANDING COMPONENTS OF DISTRICT <input checked="" type="checkbox"/>		COMPLEX <input type="checkbox"/>
(Include individual survey number ONLY if surveyed individually.)		
MAP NUMBER: 25	DATE BUILT: mid 20th	SURVEY NUMBER:
FUNCTIONAL TYPE: Garage	NEGATIVE FILE NUMBER:	
COMMON NAME:	OWNER: Winton & Alma Patnode	
DESCRIPTION:		
<p>A gable-front, clapboarded garage with an asphalt shingle-covered roof. Non-contributing.</p>		
MAP NUMBER: 26	DATE BUILT: c.1850	SURVEY NUMBER:
FUNCTIONAL TYPE: Residence	NEGATIVE FILE NUMBER: 81-A-72	
COMMON NAME:	OWNER: Winton & Alma Patnode	
DESCRIPTION:		
<p>A 2½-story, gable-front house with a 2-story, hip roofed left wing. It has an asphalt shingle-covered roof, an interior brick chimney, a molded cornice, clapboard siding, and cornerboards. There is a new picture window in front while other windows are 2/1 with lip molded lintels. In the gable is a horizontal Queen Anne window with small, colored panes surrounding a large light. This was probably added at the turn of the century, the porch which is rounded and has turned posts on pedestals and brackets with pendants. The left wing has similar detail on its porch, 2/2 windows and a concrete chimney behind the ridge. It has new windows on the first floor and a stone foundation. This part of the house was originally a carriage house; the barn on the Mac Isaac's property (#30)</p>		
MAP NUMBER: 26 cont.	DATE BUILT:	SURVEY NUMBER:
FUNCTIONAL TYPE:	NEGATIVE FILE NUMBER:	
COMMON NAME:	OWNER:	
DESCRIPTION:		
<p>was attached to it.</p> <p>The Montgomery's originally owned and built the house.</p>		
MAP NUMBER: 27	DATE BUILT: c.1820, c.1860	SURVEY NUMBER:
FUNCTIONAL TYPE: Residence	NEGATIVE FILE NUMBER: 81-A-72	
COMMON NAME:	OWNER: Adolph and June DeSarno	
DESCRIPTION:		
<p>A 1½-story, eaves-front house with an interior brick chimney on each side. It has a molded cornice, clapboard siding, and cornerboards. Windows are 2/2 with lip-molded lintels. There are frieze windows which are partially covered by the 1-story porch. The porch spans the front and right facades and has pierced posts, scrolled brackets, and a pierced, decorated skirt. The right facade has a polygonal bay window which was added c.1900. On the left is a 1-story wing. The house has a stone foundation and brick nogging. It was built by a Mr. Stockman who supposedly built the first floor about 1820. The second floor was added c.1860. One of the early owners was Mr. Hurst.</p>		

OUTSTANDING COMPONENTS OF DISTRICT <input checked="" type="checkbox"/>		COMPLEX <input type="checkbox"/>
(Include individual survey number ONLY if surveyed individually.)		
MAP NUMBER: 28	DATE BUILT: early	SURVEY NUMBER:
FUNCTIONAL TYPE: Barn	20thc.	NEGATIVE FILE NUMBER: 81-A-72
COMMON NAME:	OWNER: Adolph and June DeSarno	
DESCRIPTION:		
An eaves-front barn with novelty siding and an asphalt shingle-covered roof. There is decorative cresting on the ridge.		
MAP NUMBER: 29	DATE BUILT:	SURVEY NUMBER:
FUNCTIONAL TYPE: Garage		NEGATIVE FILE NUMBER: 81-A-72
COMMON NAME:	OWNER: Dr. and Mrs. S.G. MacIsaac	
DESCRIPTION:		
A 2-stall, gable-front garage with wood shingle siding and an asphalt shingle-covered roof. It has a concrete chimney at the ridge and triple 6-light windows.		
MAP NUMBER: 30	DATE BUILT: late 19thc.	SURVEY NUMBER:
FUNCTIONAL TYPE: Barn		NEGATIVE FILE NUMBER: 81-A-72
COMMON NAME:	OWNER: Dr. and Mrs. S.G. MacIsaac	
DESCRIPTION:		
An eaves-front barn with sheet metal-covered roof and a square hip-roofed cupola. It has clapboard siding. It was moved from the Patnode's property (#26).		
MAP NUMBER: 31	DATE BUILT:	SURVEY NUMBER:
FUNCTIONAL TYPE: residence		NEGATIVE FILE NUMBER: 81-A-72
COMMON NAME: The Montgomery House	OWNER: Dr. and Mrs. S.G. MacIsaac	
DESCRIPTION:		
A 2-story, gable-front house with an eaves-front left wing. It has a molded cornice with cornice returns. The house is clad in shingles on the second floor and clapboards on the first. Although the fenestration has changed somewhat, most of the windows are 1/1 with lip-molded lintels. The porch is built in the Bungalow style; like several others on the island (see #21) it has tapered, shingled piers which extend up to the impost that curves into a plain frieze. There is a stone foundation covered with concrete, and a flat-roofed ell in the rear.		
Originally owned by John and Jennie Montgomery.		

OUTSTANDING COMPONENTS OF DISTRICT ☒ COMPLEX ☐
(Include individual survey number ONLY if surveyed individually.)

MAP NUMBER:	DATE BUILT:	SURVEY NUMBER:
FUNCTIONAL TYPE:	NEGATIVE FILE NUMBER:	
COMMON NAME:	OWNER:	
DESCRIPTION:		

MAP NUMBER:	DATE BUILT:	SURVEY NUMBER:
FUNCTIONAL TYPE:	NEGATIVE FILE NUMBER:	
COMMON NAME:	OWNER:	
DESCRIPTION:		

MAP NUMBER:	DATE BUILT:	SURVEY NUMBER:
FUNCTIONAL TYPE:	NEGATIVE FILE NUMBER:	
COMMON NAME:	OWNER:	
DESCRIPTION:		

MAP NUMBER:	DATE BUILT:	SURVEY NUMBER:
FUNCTIONAL TYPE:	NEGATIVE FILE NUMBER:	
COMMON NAME:	OWNER:	
DESCRIPTION:		



0703-13 #1

81-A-61

Vt. Div. for Historic Preservation
Grand Isle Cnty., Isle La Motte NW
0703-13 Village Ctr. District #1
81-A-61 Karen L. Kiemnec



0703-13 #2

81-A-61

Vt. Div. for Historic Preservation
Grand Isle Cnty., Isle La Motte NE
0703-13 Village Ctr. Dist. #2,
library
81-A-61 Karen L. Kiemnec



0703-13 #3

81-A-61

Vt. Div. for Historic Preservation
Grand Isle Cnty., Isle La Motte SE
0703-13 Village Ctr. Dist. #3 ,
Town Office
81-A-61 Karen L. Kiemnec



0703-13 #6

81-A-61

Vt. Div. for Historic Preservation
Grand Isle Cnty., Isle La Motte NW
0703-13 Village Ctr. Dist. #6,
Masons

81-A-61

Karen L. Kiemnec



0703-13 #7

81-A-61

Vt. Div. for Historic Preservation
Grand Isle Cnty., Isle La Motte SW
0703-13 Village Ctr. Dist. #7
81-A-61 Karen L. Kiemnec



0703-13 #7

81-A-61

Vt. Div. for Historic Preservation
Grand Isle Cnty., Isle La Motte NW
0703-13 Village Ctr. Dist. #7 door
detail
81-A-61 Karen L. Kiemnec

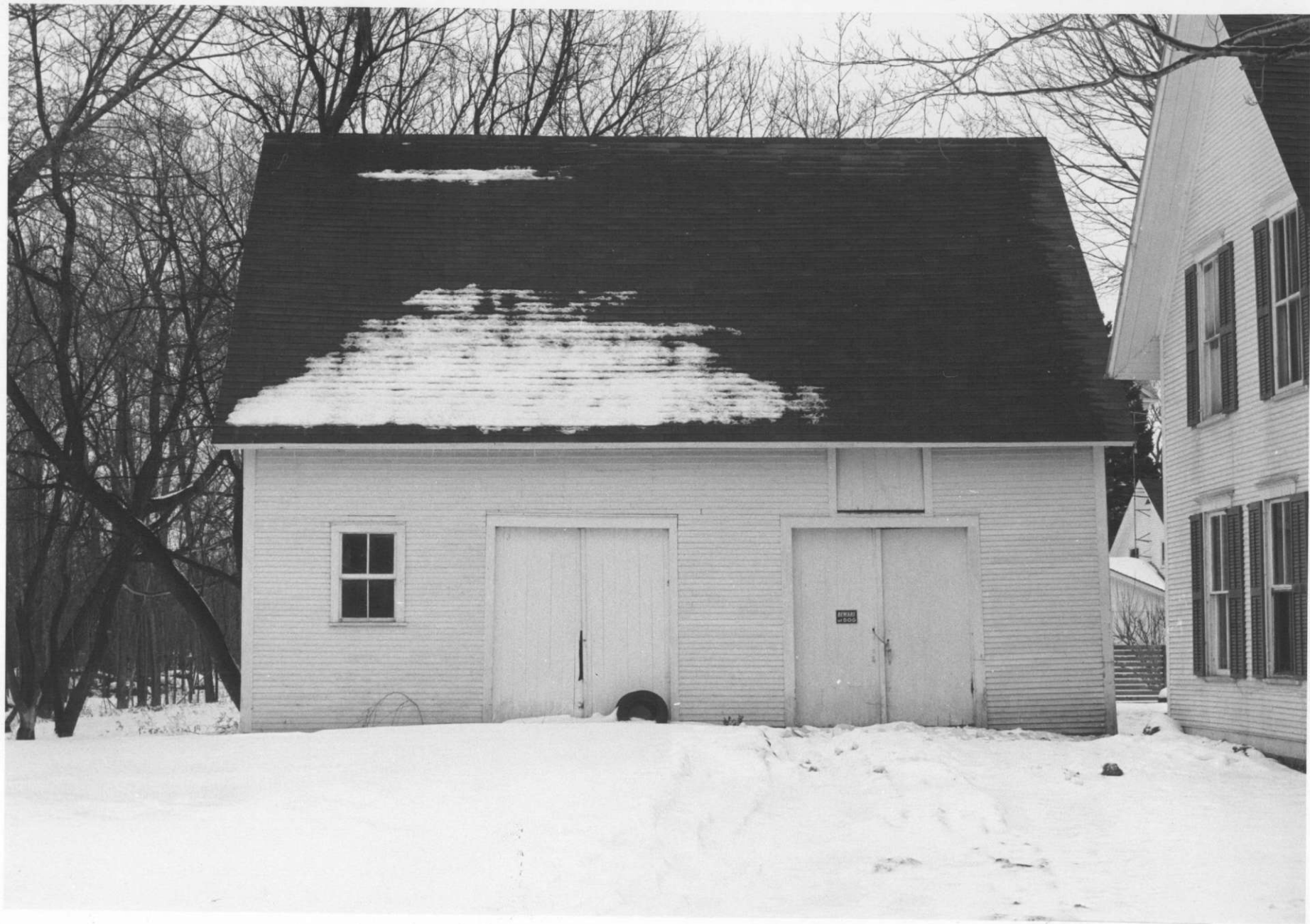

0703-13 #8

81-A-61

Vt. Div. for Historic Preservation
Grand Isle Cnty., Isle La Motte W
0703-13 Village Ctr. Dist. #8 barn
81-A-61 Karen L. Kiemnec



0703-13 #9

81-A-61

Vt. Div. for Historic Preservation
Grand Isle Cnty., Isle La Motte NE
0703-13 Village Ctr. Dist. #9
Main Block

81-A-61 Karen L. Kiemnec



0703-13 #9

81-A-61

Vt. Div. for Historic Preservation
Grand Isle Cnty., Isle La Motte NE
0703-13 Village Ctr. Dist. #9 left
wing
81-A-61 Karen L. Kiemnec



0703-13 #10

81-A-61

Vt. Div. for Historic Preservation
Grand Isle Cnty., Isle La Motte N
0703-13 Village Ctr. Dist. #10
Yoke House
81-A-61 Karen L. Kiemnec



0703-13 #11

81-A-61

Vt. Div. for Historic Preservation
Grand Isle Cnty., Isle La Motte NE
0703-13 Village Ctr. Dist. #11
Church
81-A-61 Karen L. Kiemnec



0703-13 #12

81-A-61

Vt. Div. for Historic Preservation
Grand Isle Cnty., Isle La Motte SE
0703-13 Village Ctr. Dist. #12
Andrews'
81-A-61 Karen L. Kiemnec



0703-13 #12

81-A-61

Vt. Div. for Historic Preservation
Grand Isle Cnty., Isle La Motte E
0703-13 Village Ctr. Dist. #12
Andrews' porch post
81-A-61 Karen L. Kiemnec



0703-13 #13

81-A-61

Vt. Div. for Historic Preservation
Grand Isle Cnty., Isle La Motte SW
0703-13 Village Ctr. Dist. #13 barn
81-A-61 Karen L. Kiemnec



0703-13 #14

81-A-61

Vt. Div. for Historic Preservation
Grand Isle Cnty., Isle La Motte NE
0703-13 Village Ctr. Dist. #14
Beard
81-A-61 Karen L. Kiemnec



0703-13 #15

81-A-72

Vt. Div. for Historic Preservation
Grand Isle Cnty., Isle La Motte SE
0703-13 Village Ctr. District #15
81-A-72 Karen L. Kiemnec



0703-13 #17

81-A-72

Vt. Div. for Historic Preservation
Grand Isle Cnty., Isle La Motte NE
0703-13 Village Ctr. District, #17
La Bombards

81-A-72 Karen L. Kiemnec



0703-13 #18

81-A72

Vt. Div. for Historic Preservation
Grand Isle Cnty., Isle La Motte NE
0703-13 Village Ctr. District
Stanley LaBombards #18
81-A-72 Karen L. Kiemnec



0703-13 #20

81-A-72

Vt. Div. for Historic Preservation
Grand Isle Cnty., Isle La Motte SE
0703-13 Village Ctr. District
#20 *Patno de* garage
81-A-72 Karen L. Kiemnec



0703-13 #21

81-A-72

Vt. Div. for Historic Preservation
Grand Isle Cnty., Isle La Motte NE
0703-13 Village Ctr. District #21
Patnode
81-A-72 Karen L. Kiemnec



0703-13 #22

81-A-72

Vt. Div. for Historic Preservation
Grand Isle Cnty., Isle La Motte E
0703-13 Village Ctr. District
#22 front
81-A-72 Karen L. Kiemnec



0703-13 #22

81-A-72

Vt. Div. for Historic Preservation
Grand Isle Cnty., Isle La Motte S
0703-13 Village Ctr. District
#22 window detail.

81-A-72

Karen L. Kiemnec



0703-13 #23

81-A-72

Vt. Div. for Historic Preservation
Grand Isle Cnty., Isle La Motte
0703-13 Village Ctr. District
#23 barn
81-A-72 Karen L. Kiemnec



0703-13 #26

81-A-72

Vt. Div. for Historic Preservation
Grand Isle Cnty., Isle La Motte NW
0703-13 Village Ctr. District
#26 Winton Patnode
81-A-72 Karen L. Kiemnec



0703-13 #27

81-A-72

Vt. Div. for Historic Preservation
Grand Isle Cnty., Isle La Motte NE
0703-13 Village Ctr. District
#27 DeSarno
81-A-72 Karen L. Kiemnec



0703-13 #28

81-A-72

Vt. Div. for Historic Preservation
Grand Isle Cnty., Isle La Motte NE
0703-13 Village Ctr. District
#28 DeSarno
81-A-72 Karen L. Kiemnec



0703-13 #29

81-A-72

Vt. Div. for Historic Preservation
Grand Isle Cnty., Isle La Motte NW
0703-13 Village Ctr. District
#29 Mac Isaacs
81-A-72 Karen L. Kiemnec



0703-13 #30

81-A-72

Vt. Div. for Historic Preservation
Grand Isle Cnty., Isle La Motte W
0703-13 Village Ctr. District
#30 Mac Isaacs
81-A-72 Karen L. Kiemnec



0703-13 #31

81-A-72

Vt. Div. for Historic Preservation
Grand Isle Cnty., Isle La Motte W
0703-13 Village Ctr. District
#31 Mac Isaacs
81-A-72 Karen L. Kiennec